



 STEP-files S620

S620



Serie 620

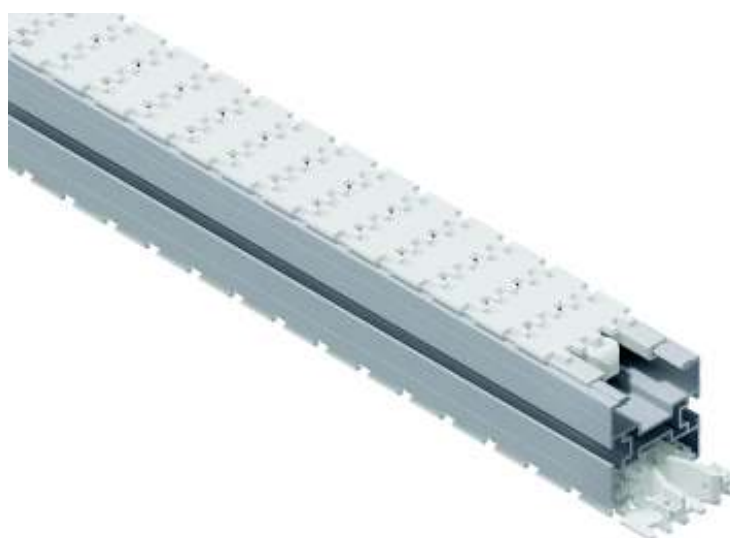

Technical specification S620	
Width of chain	62 mm
Chain pitch	30 mm
Width conveyor profile	64 mm
Height conveyor	78 mm
Radius conveyor chain on the drive and idler unit	70 mm
Max. permitted traction on the conveyor chain	500 N
Weight conveyor	≈ 5 kg/m **
Recommended maximum weight on conveyor	≈ 105 kg *
Recommended maximum load	≈ 10 kg/m *
Recommended maximum length of conveyor	≈ 20 m *
Recommended maximum speed	60 m/min
Minimum radius on horizontal bend	R 191 mm
Wheel curve radius	R 141 mm and R191
Vertical bend radius	R 400 mm och R 860 mm
Motor	0,18 - 0,37 kW
Noise level	< 70 dB (A)
Chain material	Acetal
Conveyor profile material	Anodized aluminum
* Recommended maximum length depends on the design, load and number of bends.	
** The weight of the conveyor depends on which type of chain, guide rail and guide rail bracket.	

Serie 620

Conveyor profile S620

Anodized aluminum
Weight 2150 g/m
Length 5.8 m
Qty/ package 16 pcs

Part no. 620-1000

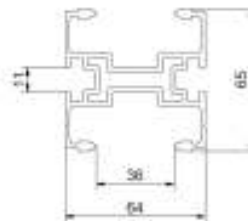

Serie 620

Conveyor chain S620

Acetal, nylon and stainless steel.

Standard version top flights are made of white acetal which is food approved
 Allowed traction force 500 N.

On request, chain and top flight can be delivered in non-standard material.

Enter the following additional letter.

L = Low friction

V = Heat resistance

A = Antistatic

F = Flocked

Order example 620-2000L

Finger chain

Slat standard chain for S620 och S520

Weight 760 g/m

Qty 33 pcs/m

Part no. 620-2000

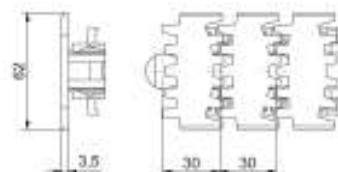

Link for standard chain

Part no. 620-2001

Finger chain friction

Standard chain with friction S620 och

S520

Weight 770 g/m

Qty 33 st/m

Part no. 620-2010

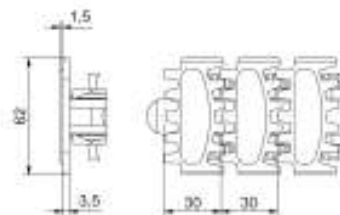

Link for friction chain

Part no. 620-2011

Serie 620

V-chain

For S620 and S520
 Weight 880 g/m
 Qty 33 pcs/m

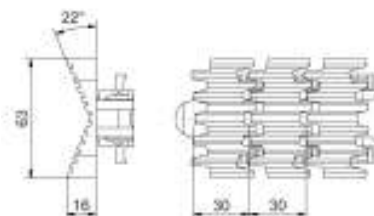

Part no. 620-2130

Link for v-chain
Part no. 620-2131

V-chain

For S620 and S520
 Weight 890 g/m
 Qty 33 pcs/m

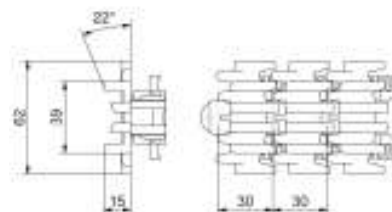

Part no. 620-2135

Link for v-chain
Part no. 620-2136

Chain for straight running

For S620 and S520
 Weight 700 g/m
 Qty 50 pcs/m

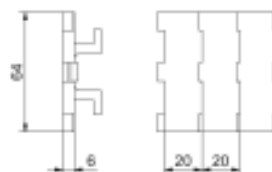

Part no. 620-2200

Link for straight running chain
Part no. 620-2201

Link to straight running chain with carrier

For S620 and S520
 Weight 15 g

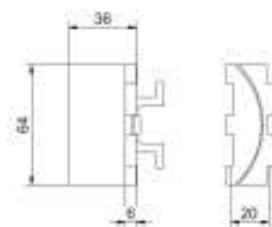

Part no. 620-2210

Serie 620

Chain with carrier

For S620 and S520
Weight 880 g/m
Qty 33 pcs/m

Part no. 620-2067

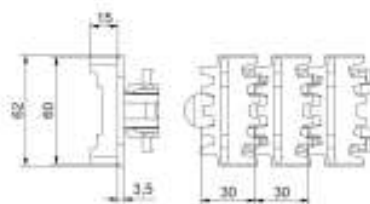

Link for carrier chain
Part no. 620-2068

Link with carrier

For S620 and S520
Weight 28 g

Art.nr 620-2065

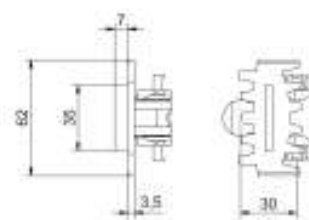

Link with carrier

For S620 and S520
Weight 30 g

Art.nr 620-2179

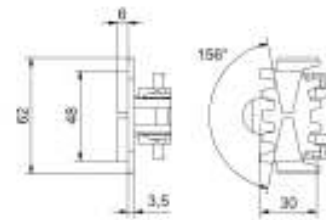

Link with carrier

For S620 and S520
Weight 35 g

Art.nr 620-2189

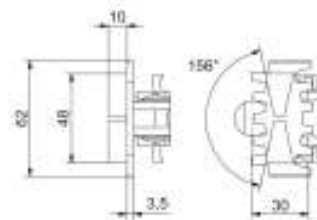

Serie 620

620-30

Drive unit with direct transmission S620.
Configuration of default drive with direct transmission **620-30-ABC-D-E**.



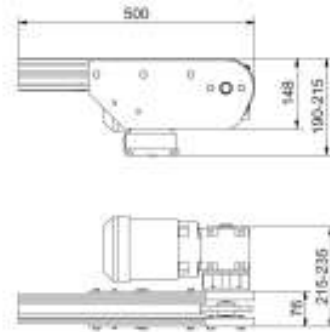

If needed, roller transfers and brackets can be found at page 110.

Weight without motor 3500 g
Weight with motor 10500-16500 g

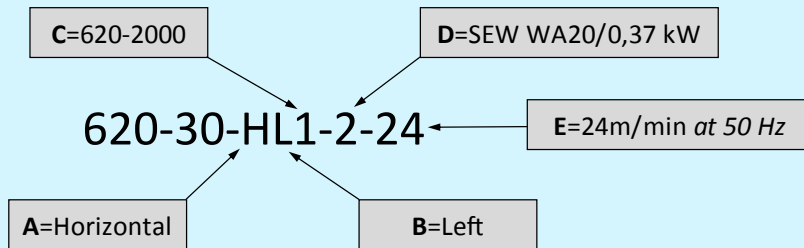

Order example



A: <u>Assembly position</u>	B: <u>Placement</u>	C: <u>Conveyor chain</u>	D: <u>Motor/gear power</u>	E: <u>Speed m/min at 50 Hz</u>
H: Horizontal 	R: Right 	1: 620-2000 620-2010	1: SEW WA20 0,25 kW	8 18 55 10 23 15 32 16 44
		2: 620-2189 620-2179		2: SEW WA20 0,37 kW
V: Vertical 	L: Left 	3: 620-2065 620-2135	3: SEW WA30 0,37 kW	6 15 29 8 17 33 10 19 46 12 24 57
		4: 620-2130		
				W Without motor/gear. Assembly position and shaft prepared for selected placement. More options →

Serie 620

Cont. 620-30

D: Motor/gear Power	E: Speed m/min at 50 Hz		
5: SEW SA37 0,37 kW	8 10 13 16	19 24 27 31	36
6: Lenze G500-B45 0,18 kW	13 15 17 19	21 25 28 31	36 41 45 52
7: Lenze G500-B110 0,18 kW	8 10 12 15	19 21 25 33	38 41
8: Lenze G500-B45 0,25 kW	19 22 25 28	32 36 41 46	52
9: Lenze G500-B110 0,25 kW	11 12 15 19	21 25 27 31	38 42 46 52
10: Lenze G500-B45 0,37 kW	28 32 37 42	47 54	

D: Motor/gear Power	E: Speed m/min at 50 Hz		
11: Lenze G500-B110 0,37 kW	11 13 16 20	22 25 28 32	34 39 43 47
14: Lenze Smart Motor G500-B45 0,25 kW			Adjustable speed 6-31 m/min
15: Lenze Smart Motor G500-B45 0,25 kW			Adjustable speed 10-50 m/min
			W Without motor/gear. Assembly position and shaft prepared for selected place- ment.

If needed, roller transfers and brackets can be found at page 110.

Serie 620

Cont. 620-30

Bracket for roller transfer and connecting strip between conveyors

The following configuration is listed on order number 620-30-ABC-D-E- **with one additional letter**.

A = 900-3117 and 900-7112.

B = 900-3119 and 900-7120.

C = 900-3118 and 900-7130, 7 mm level difference.

Order example 620-30-HL1-2-24-A

A**B****C**

Bracket for roller transfer and connecting strip including roller transfer

The following configuration is listed on the existing order number 140-30-ABC-D-E- **with two extra letters**.

AR = 900-3117, 900-7112 and 900-7000

BR = 900-3119, 900-7120 and 900-7000

CR = 900-3118, 900-7130 and 900-7000, 7 mm level difference.

Order example: 620-30-HL1-2-24-AR

AR**BR****CR**

Serie 620

620-31

Drive unit with suspended motor S620.
Configuration of default drive



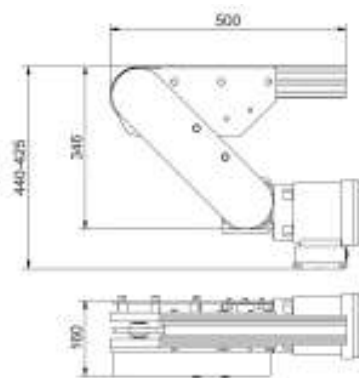

620-31-ABC-D-E.

If needed, roller transfers and brackets can be found at page 115.

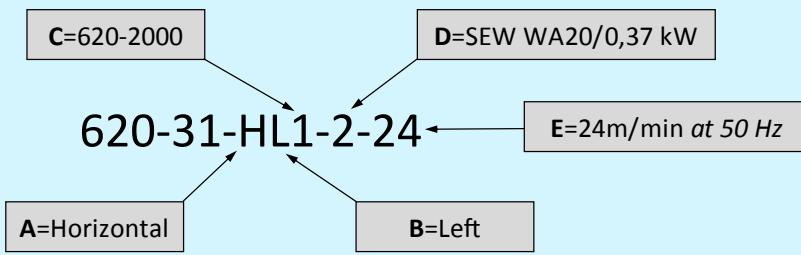

Order example



A: <u>Assembly position</u>	B: <u>Placement</u>	C: <u>Conveyor chain</u>	D: <u>Motor/gear power</u>	E: <u>Speed m/min at 50 Hz</u>
H: Horizontal 	R: Right 	1: 620-2000 620-2010	1: SEW WA20 0,25 kW	8 18 55 10 23 15 32 16 44
		2: 620-2189 620-2179		2: SEW WA20 0,37 kW
V: Vertical 	L: Left 	3: 620-2065 620-2135	3: SEW WA30 0,37 kW	6 15 29 8 17 33 10 19 46 12 24 57
		4: 620-2130		
				W Without motor/gear. Assembly position and shaft prepared for selected placement. More options →

Serie 620

Cont. 620-31

D: Motor/gear Power	E: Speed m/min at 50 Hz		
5: SEW SA37 0,37 kW	8 10 13 16	19 24 27 31	36
6: Lenze G500-B45 0,18 kW	13 15 17 19	21 25 28 31	36 41 45 52
7: Lenze G500-B110 0,18 kW	8 10 12 15	19 21 25 33	38 41
8: Lenze G500-B45 0,25 kW	19 22 25 28	32 36 41 46	52
9: Lenze G500-B110 0,25 kW	11 12 15 19	21 25 27 31	38 42 46 52
10: Lenze G500-B45 0,37 kW	28 32 37 42	47 54	

D: Motor/gear Power	E: Speed m/min at 50 Hz		
11: Lenze G500-B110 0,37 kW	11 13 16 20	22 25 28 32	34 39 43 47
14: Lenze Smart Motor G500-B45 0,25 kW			Adjustable speed 6-31 m/min
15: Lenze Smart Motor G500-B45 0,25 kW			Adjustable speed 10-50 m/min
			W Without motor/gear. Assembly position and shaft prepared for selected place- ment.

If needed, roller transfers and brackets can be found at page 115.

Serie 620

Cont. 620-31

Bracket for roller transfer and connecting strip between conveyors

The following configuration is listed on order number 620-31-ABC-D-E- **with one additional letter.**

A = 900-7112.

B = 900-7120.

C = 900-7130, with 7 mm level difference

Order example 620-31-HL1-2-24-A

A



B



C



Bracket for roller transfer and connecting strip including roller transfer

The following configuration is listed on the existing order number 620-31-ABC-D-E- **with two extra letters.**

AR = 900-7112 and 900-7000

BR = 900-7120 and 900-7000

CR = 900-7130 and 900-7000, 7 mm level difference between conveyor.

Order example: 620-31-HL1-2-24-AR

AR



BR



CR



Serie 620



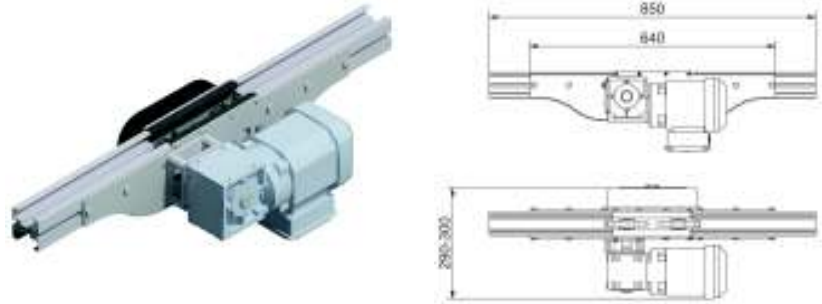

620-32

Drive unit with intermediate motor and returnchain S620.
Configuration of default drive
620-32-AB-C-D.

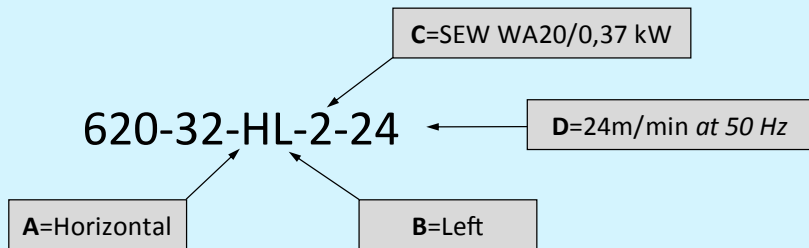

Order example



<u>A:</u> <u>Assembly position</u>	<u>B:</u> <u>Placement</u>	-	<u>C:</u> <u>Motor/gear power</u>	<u>D:</u> <u>Speed m/min at 50 Hz</u>												
H: Horizontal 	R: Right 		1: SEW WA20 0,25 kW	<table style="margin: auto;"> <tr><td>8</td><td>18</td><td>55</td></tr> <tr><td>10</td><td>23</td><td></td></tr> <tr><td>15</td><td>32</td><td></td></tr> <tr><td>16</td><td>44</td><td></td></tr> </table>	8	18	55	10	23		15	32		16	44	
8	18	55														
10	23															
15	32															
16	44															
			2: SEW WA20 0,37 kW	<table style="margin: auto;"> <tr><td>17</td><td>33</td><td></td></tr> <tr><td>19</td><td>46</td><td></td></tr> <tr><td>24</td><td>57</td><td></td></tr> <tr><td>29</td><td></td><td></td></tr> </table>	17	33		19	46		24	57		29		
17	33															
19	46															
24	57															
29																
V: Vertical 	L: Left 		3: SEW WA30 0,37 kW	<table style="margin: auto;"> <tr><td>6</td><td>15</td><td>29</td></tr> <tr><td>8</td><td>17</td><td>33</td></tr> <tr><td>10</td><td>19</td><td>46</td></tr> <tr><td>12</td><td>24</td><td>57</td></tr> </table>	6	15	29	8	17	33	10	19	46	12	24	57
6	15	29														
8	17	33														
10	19	46														
12	24	57														
			W Without motor/gear. Assembly position and shaft prepared for selected placement. More options →													

Serie 620

Cont. 620-32

C: Motor/gear power	D: Speed m/min at 50 Hz		
5: SEW SA37 0,37 kW	8 10 13 16	19 24 27 31	36
6: Lenze G500-B45 0,18 kW	13 15 17 19	21 25 28 31	36 41 45 52
7: Lenze G500-B110 0,18 kW	8 10 12 15	19 21 25 33	38 41
8: Lenze G500-B45 0,25 kW	19 22 25 28	32 36 41 46	52
9: Lenze G500-B110 0,25 kW	11 12 15 19	21 25 27 31	38 42 46 52
10: Lenze G500-B45 0,37 kW	28 32 37 42	47 54	





C: Motor/gear power	D: Speed m/min at 50 Hz		
11: Lenze G500-B110 0,37 kW	11 13 16 20	22 25 28 32	34 39 43 47
14: Lenze Smart Motor G500-B45 0,25 kW			Adjustable speed 6-31 m/min
15: Lenze Smart Motor G500-B45 0,25 kW			Adjustable speed 10-50 m/min
			W Without motor/gear. Assembly position and shaft prepared for selected place- ment.

Serie 620

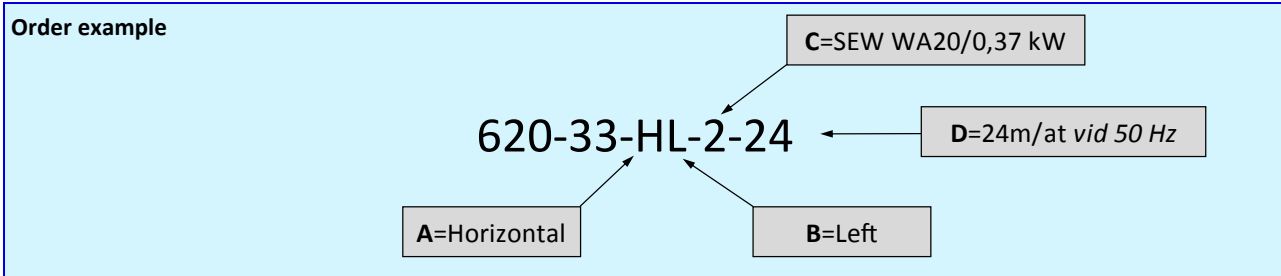
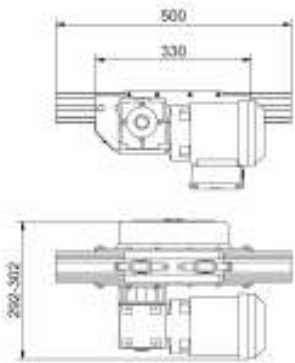
620-33

Catenary drive unit for circuit conveyor S620.
 Configuration of default drive
620-33-AB-C-D.



<u>A:</u> Assembly position	<u>B:</u> Placement	<u>C:</u> Motor/gear power	<u>D:</u> Speed m/min at 50 Hz
H: Horizontal 	R: Right 	1: SEW WA20 0,25 kW	8 18 55 10 23 15 32 16 44
V: Vertical 	L: Left 	2: SEW WA20 0,37 kW	17 33 19 46 24 57 29
		3: SEW WA30 0,37 kW	6 15 29 8 17 33 10 19 46 12 24 57
			W Without motor/gear. Assembly position and shaft prepared for selected placement. More options →

Serie 620

Cont. 620-33

C: Motor/gear power	D: Speed m/min at 50 Hz		
5: SEW SA37 0,37 kW	8 10 13 16	19 24 27 31	36
6: Lenze G500-B45 0,18 kW	13 15 17 19	21 25 28 31	36 41 45 52
7: Lenze G500-B110 0,18 kW	8 10 12 15	19 21 25 33	38 41
8: Lenze G500-B45 0,25 kW	19 22 25 28	32 36 41 46	52
9: Lenze G500-B110 0,25 kW	11 12 15 19	21 25 27 31	38 42 46 52
10: Lenze G500-B45 0,37 kW	28 32 37 42	47 54	

C: Motor/gear power	D: Speed m/min at 50 Hz		
11: Lenze G500-B110 0,37 kW	11 13 16 20	22 25 28 32	34 39 43 47
14: Lenze Smart Motor G500-B45 0,25 kW			Adjustable speed 6-31 m/min
15: Lenze Smart Motor G500-B45 0,25 kW			Adjustable speed 10-50 m/min
			W Without motor/gear. Assembly position and shaft prepared for selected place- ment.

Serie 620

620-40

Drive unit for straight conveyor.
Configuration of default drive
620-40-AB-C-D.

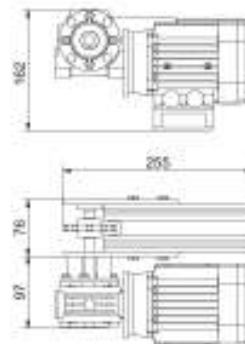

Order example





620-40-**HL**-2-24

A=Horizontal

C=Bonfiglioli VF30P-B14/0,25 kW

D=24m/min at 50 Hz

B=Left

<p>A: <u>Assembly position</u></p>	<p>B: <u>Placement</u></p>	<p>C: <u>Motor/gear power</u></p>	<p>D: <u>Speed m/min at 50 Hz</u></p>								
<p>H: Horizontal</p> 	<p>R: Right</p> 	<p>1: Bonfiglioli VF30P-B5 0,09 kW</p>	<table border="1"> <tr><td>7</td><td>23</td></tr> <tr><td>8</td><td>30</td></tr> <tr><td>11</td><td>46</td></tr> <tr><td>15</td><td></td></tr> </table>	7	23	8	30	11	46	15	
7	23										
8	30										
11	46										
15											
<p>V: Vertical</p> 	<p>L: Left</p> 	<p>2: Bonfiglioli VF30P-B14 0,25 kW</p>	<table border="1"> <tr><td>8</td><td>30</td></tr> <tr><td>11</td><td>46</td></tr> <tr><td>15</td><td></td></tr> <tr><td>23</td><td></td></tr> </table>	8	30	11	46	15		23	
8	30										
11	46										
15											
23											
			<p>W Without motor/gear. Assembly position and shaft prepared for selected placement. More options →</p>								

Serie 620

Idler unit

Standard idler unit for S620
Weight 2200 g

Part no. 620-4005

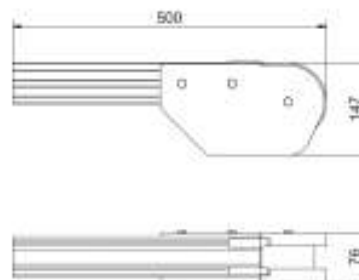

Bracket for roller transfer and bracket including roller transfer

The following configuration is listed on the existing order number 620-4005- **with one/ or two additional letter**.

A = 900-7111

AR = 900-7111 and 900-7000

Order example: 620-4005-A

A



AR



Serie 620

Idler unit

Used as front idler unit for conveyor where drive unit 620-32 is included .

Part no. 620-4055

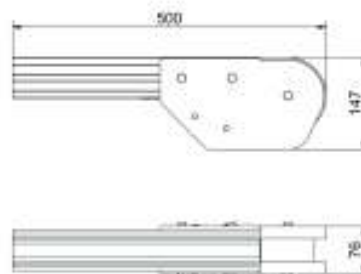

Bracket for roller transfer and bracket including roller transfer

The following configuration is listed on the existing order number 620-4055- **with one/ or two additional letter**.

A = 900-7112

AR = 900-7112 and 900-7000

Order example: 620-4055-A

A



AR



Serie 620

Idler unit

Idler unit 90° for S620

Part no. 16970

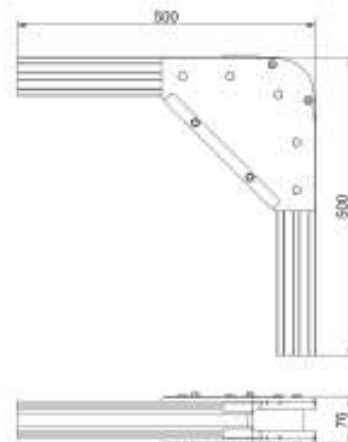

Bracket for roller transfer and bracket including roller transfer

The following configuration is listed on the existing order number 16970- **with one/ or two additional letter.**

A = 900-7111

AR = 900-7111 and 900-7000

Order example: 16970-A

A



AR



Serie 620

Idler unit

Used for straight going chain together with drive 620-40.

Part no. 620-4060

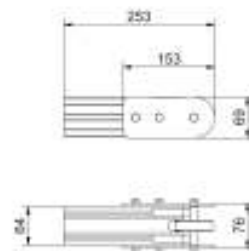

Serie 620

Wheel bend

Standard wheel bend S620 with R141 mm
Aluminum profile and wheel in plastic

Configuration of default wheel bend

Part no. 620-5025-A

A= Angle on bend

Standard angles for R141
A = 45°
A = 90°
A = 180°

Other angles are manufactured on request
Connecting strip 100-7010 is ordered separately

Order example

620-5025-45

A= 45°

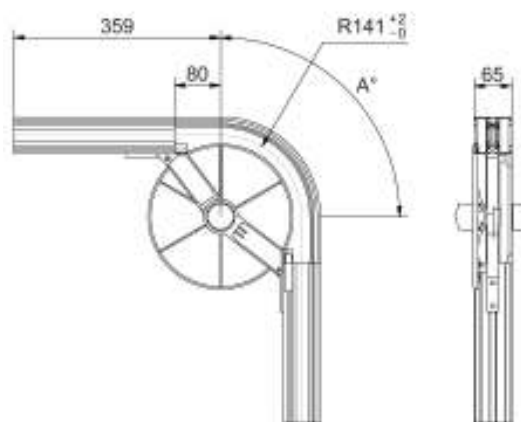

Serie 620

Wheel bend

Standard wheel bend S620 with R 191 mm
Aluminum profile and wheel in plastic

Configuration of default wheel bend
Art.nr 620-5055-A

A= Angle on bend

Standard angles for R191
A = 45°
A = 90°
A = 180°

Other angles are manufactured on request
Connecting strip 100-7010 is ordered separately

Order example

620-5055-45

A= 45°

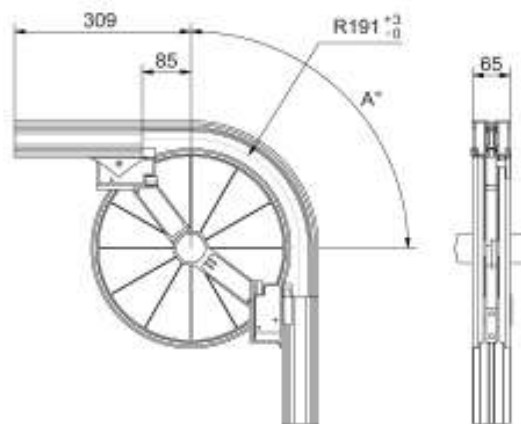

Serie 620

Adjustable support assembly

Support assembly for wheel bend R141 S620
Complete with shaft
Zinc die-cast and stainless steel
Weight 690 g

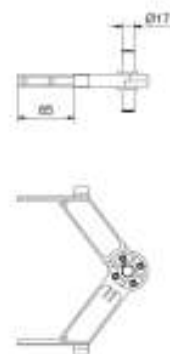

Part no. 830-5026

Adjustable support assembly

Support assembly for wheel bend R191 S620
Complete with shaft
Zinc die-cast and stainless steel
Weight 1380 g

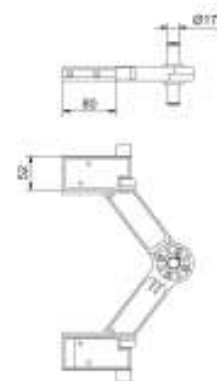

Part no. 830-5056

Spacer

For adjustable support assembly
Zinc die-cast
Weight 240 g

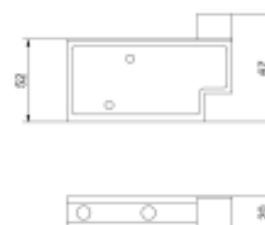

Part no. 830-5057

Serie 620

Shaft

For wheel bend R141
Stainless steel
Weight 145 g

Part no. 830-5028

**Shaft**

For wheel bend R191
Stainless steel
Weight 165 g

Part no. 830-5058

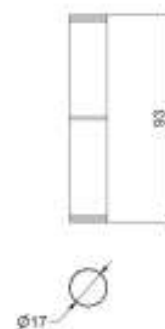
**Pinch guard**

For wheel bend R141
Black polyamide
Weight 6 g

Part no. 830-5029

**Pinch guard**

For wheel bend R191
Black polyamide
Weight 11 g

Part no. 830-5059

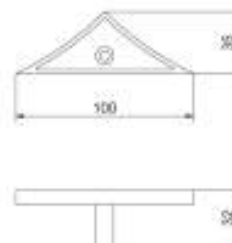

Serie 620

Disc

To wheel bend R141
Complete with bearing 6003-2Z
Black nylon

Weight 335 g

Part no. 830-5027

**Disc**

To wheel bend R191
Complete with bearing 6203-2Z
Black nylon

Weight 825 g

Part no. 830-5060

**Plastic cover**

To wheel bend Ø252
Black PVC
Weight 11 g

Part no. 830-5031

**Plastic cover**

To wheel bend Ø350
Black PVC
Weight 15 g

Part no. 830-5062

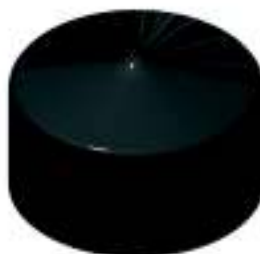

Serie 620

Plain bend

Standard plain bend S620 consists of two aluminum profiles and plastic clamp

Plain bend configuration
Part no. 620-5375-A-B

A= Bend radius
B= Angle on bend
The following radius and angles are standard



A = Radius	B = Angle
191 mm	15°, 30°, 45°, 90°, 180°
289 mm	15°, 30°, 45°, 90°, 180°
389 mm	15°, 30°, 45°, 90°, 180°
489 mm	15°, 30°, 45°, 90°, 180°
589 mm	15°, 30°, 45°, 90°, 180°

Other radius and angles are manufactured on request

Order example

620-5375-600-90

A= 600 mm

B= 90°

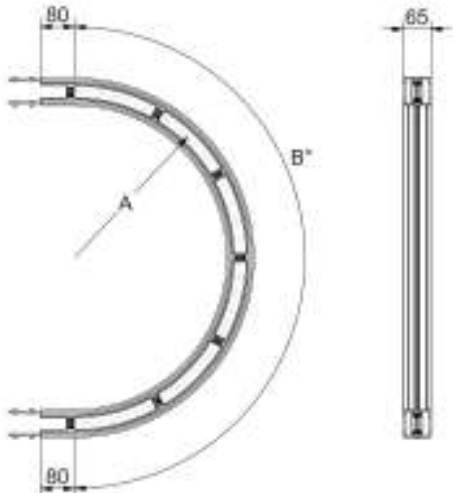

Serie 620

Vertical bend

Standard vertical bend R400
Anodized aluminum and curve clamps in plastic

Vertical bend configuration

Part no. 620-5645-A

A= Angle on bend

Standard angles for R400
A = 10°
A = 15°
A = 20°
A = 30°
A = 45°
A = 60°
A = 90°

Other radius and angles are manufactured on request.
Minimum 10°

Order example

620-5645-45

A = 45°

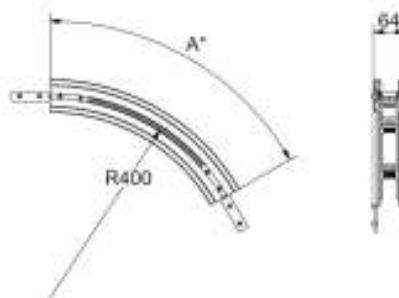

Serie 620

Vertical bend

Standard vertical bend R860
Anodized aluminum and curve clamps in plastic

Vertical bend configuration
Part no. 620-5695-A

A= Angle on bend

Standard angles for R860
A = 5°
A = 10°
A = 15°
A = 20°
A = 30°
A = 45°
A = 60°
A = 90°

Other radius and angles are manufactured on request.
Minimum 5°

Order example

620-5695-45

A= 45°

